



FLANDERS HILL

at WESTBOROUGH



Casual Luxury Living

Where PEACE
meets YOU



OF MIND R WAY *of living.*

Envision yourself among rolling hills with charming vista views. Now, imagine living nestled into that landscape with all the luxuries of home.

Flanders Hill at Westborough will expand your idea of suburban living. More than just a home, Flanders Hill is an entire community; a neighborhood unto itself.

Explore what our residences offer: from fully appointed loft-style living, to balconies overlooking woodland landscapes, and right on to a complete array of fitness and recreation possibilities.

Welcome to Flanders Hill at Westborough, where your idea of a home expands with new possibilities.



Where **LUX**
relaxed C



URY *mingles with* OMFORT.



- Professional, on-site management staff.
- Ample parking with attached and detached garages available.
- 24-hour emergency maintenance.
- Over 60 acres of rolling woodland landscape with open lawn areas.

A LIFESTYLE *filled with* OPT



LE IONS.

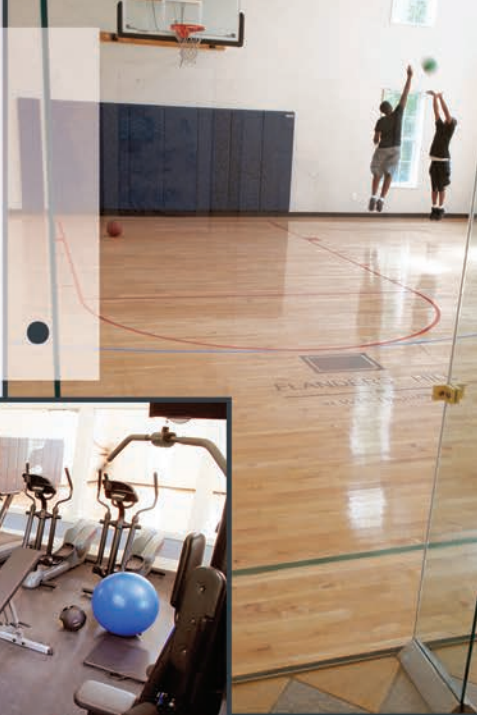

- Resort style swimming pool and spa.
- Fitness center.
- Indoor basketball court.
- Nature trails and picnic areas with community grills.
- Two playgrounds.
- Media room with wireless internet connectivity.
- Clubhouse.
- Pet-friendly community, including Pet Park.



A HOME *filled* COMFO

- Loft layouts.
- Washer and dryer in unit.
- Wooded views for select units.
- Balconies and patios.
- Vaulted ceilings.
- Fireplace in select units.
- Gas stove range.
- Dishwasher.
- Alarm.
- Cable ready.
- Air conditioning.
- Ceiling fans.



with

R T S .





■ DOG PARK



■ 3000

A COMPLETE NEIGHBORHOOD.



■ 1000

■ BUS STOP

■ SPA

■ POOL

■ LEASING OFFICE

■ GARAGE

■ MAIL

■ GARAGE

■ 5000

■ GARAGE

■ 4000

■ 6000

■ GARAGE

■ RECYCLE CENTER

■ GARAGE

■ GARAGE

■ 2000

■ 7000

■ GARAGE

■ 8000

■ MAIL

■ 10000

■ 9000

■ PLAYGROUND

■ MAIL

■ 11000

■ 13000

■ 12000

1205
1213
1225
1233

1202
1212
1222
1232

1105
1115
1125
1135

1102
1112
1122
1132

1214
1224
1234

1211
1221
1231

1114
1124
1134

1111
1121
1131

2205
2215
2225
2235

2214
2224
2234

2202
2212
2222
2232

2105
2115
2125
2135

2102
2112
2122
2132

2114
2124
2134

2111
2121
2131

7214
7224
7234

7211
7221
7231

7215
7225
7235

7114
7124
7134

7111
7121
7131

7115
7125
7135

7112
7122
7132

8001
8011
8021

8014
8024

8005
8015
8025

8002
8012
8022

8004
8014
8024

8003
8013
8023

8006
8016
8026

8007
8017
8027

8008
8018
8028

8009
8019
8029

8010
8020

8013
8023

8016
8026

8019
8029

8022
8032

8025
8035

8028
8038

8031
8041

8034
8044

8037
8047

8040
8050

8043
8053

8046
8056

8049
8059

8052
8062

8055
8065

8058
8068

8061
8071

8064
8074

8067
8077

8070
8080

8073
8083

8076
8086

8079
8089

8082
8092

8085
8095

8088
8098

8091
8101

8094
8104

8097
8107

8100
8110

8103
8113

8106
8116

8109
8119

8112
8122

8115
8125

8118
8128

8121
8131

8124
8134

8127
8137

8130
8140

8133
8143

8136
8146

8139
8149

8142
8152

8145
8155

8148
8158

8151
8161

8154
8164

8157
8167

8160
8170

8163
8173

8166
8176

8169
8179

8172
8182

8175
8185

8178
8188

8181
8191

8184
8194

8187
8197

8190
8200

8193
8203

8196
8206

8199
8209

8202
8212

8205
8215

8208
8218

8211
8221

8214
8224

8217
8227

8220
8230

8223
8233

8226
8236

8229
8239

8232
8242

8235
8245

8238
8248

8241
8251

8244
8254

8247
8257

8250
8260

8253
8263

8256
8266

8259
8269

8262
8272

8265
8275

8268
8278

8271
8281

8274
8284

8277
8287

8280
8290

8283
8293

8286
8296

8289
8299

8292
8302

8295
8305

8298
8308

8301
8311

8304
8314

8307
8317

8310
8320

8313
8323

8316
8326

8319
8329

8322
8332

8325
8335

8328
8338

8331
8341

8334
8344

8337
8347

8340
8350

8343
8353

8346
8356

8349
8359

8352
8362

8355
8365

8358
8368

8361
8371

8364
8374

8367
8377

8370
8380

8373
8383

8376
8386

8379
8389

8382
8392

8385
8395

8388
8398

8391
8401

8394
8404

8397
8407

8400
8410

8403
8413

8406
8416

8409
8419

8412
8422

8415
8425

8418
8428

8421
8431

8424
8434

8427
8437

8430
8440

8433
8443

8436
8446

8439
8449

8442
8452

8445
8455

8448
8458

8451
8461

8454
8464

8457
8467

8460
8470

8463
8473

8466
8476

8469
8479

8472
8482

8475
8485

8478
8488

8481
8491

8484
8494

8487
8497

8490
8500

8493
8503

8496
8506

8499
8509

8502
8512

8505
8515

8508
8518

8511
8521

8514
8524

8517
8527

8520
8530

8523
8533

8526
8536

8529
8539

8532
8542

8535
8545

8538
8548

8541
8551

8544
8554

8547
8557

8550
8560

8553
8563

8556
8566

8559
8569

8562
8572

8565
8575

8568
8578

8571
8581

8574
8584

8577
8587

8580
8590

8583
8593

8586
8596

8589
8599

8592
8602

8595
8605

8598
8608

8601
8611

8604
8614

8607
8617

8610
8620

8613
8623

8616
8626

8619
8629

8622
8632

8625
8635

8628
8638

8631
8641

8634
8644

8637
8647

8640
8650

8643
8653

8646
8656

8649
8659

8652
8662

8655
8665

8658
8668

8661
8671

8664
8674

8667
8677

8670
8680

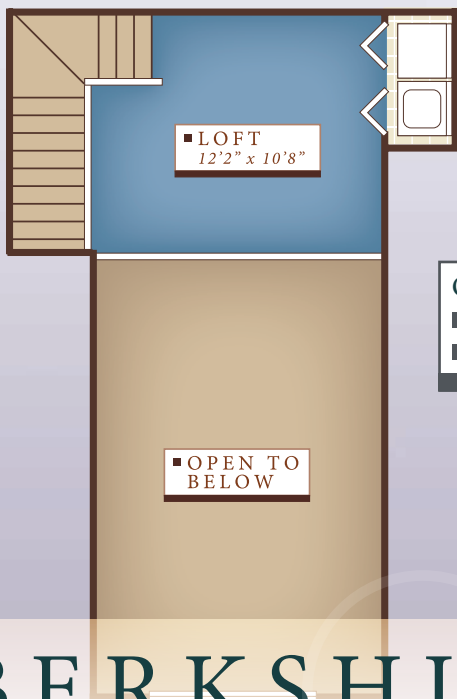
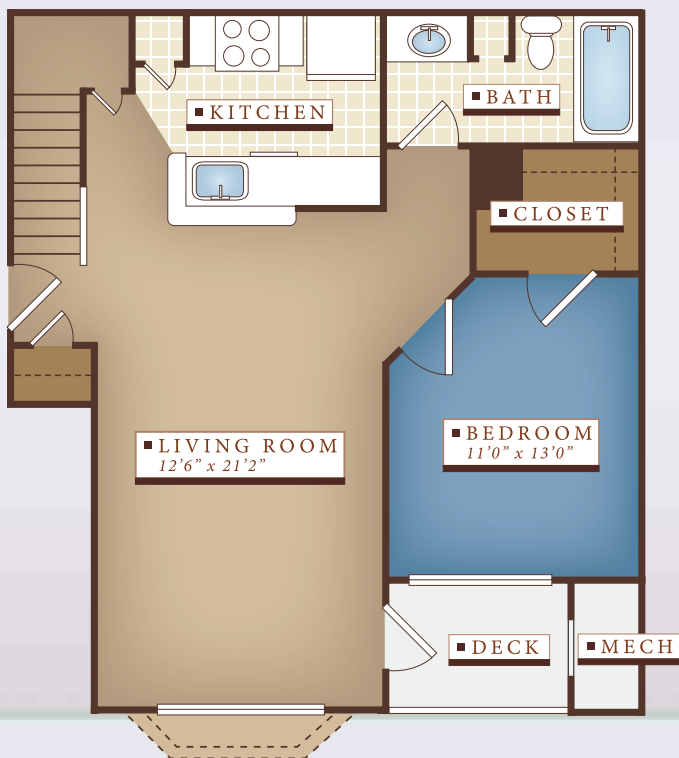

ONE BEDROOM

■ 746 square feet

■ 899 square feet with loft

The **BERKSHIRE**

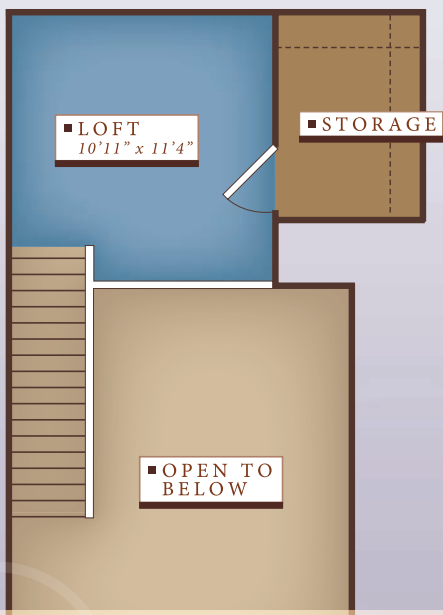
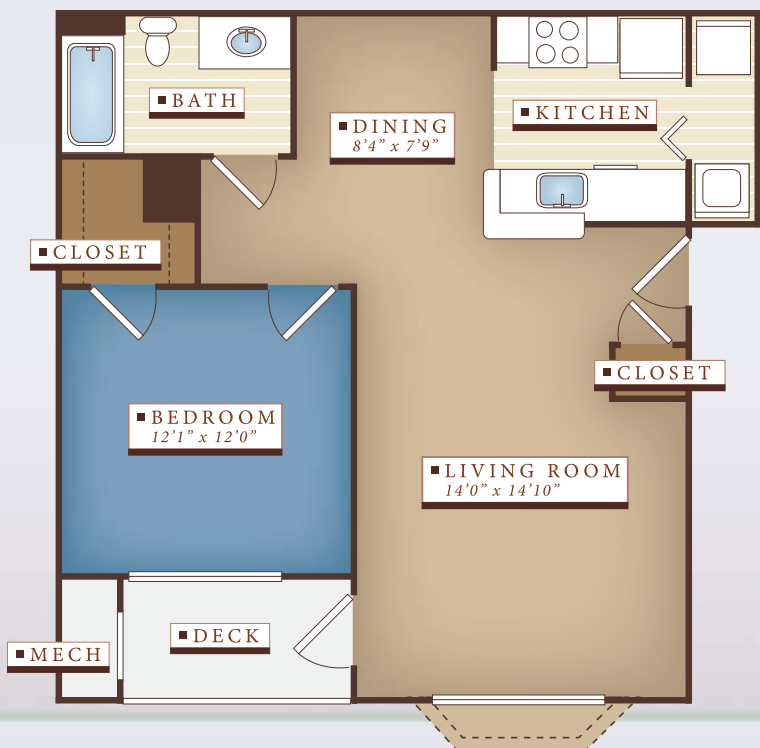

ONE BEDROOM

- 755 square feet
- 901 square feet with loft

The SUFFOLK



ONE BEDROOM
■ 851 square feet
■ 1,283 square feet with loft

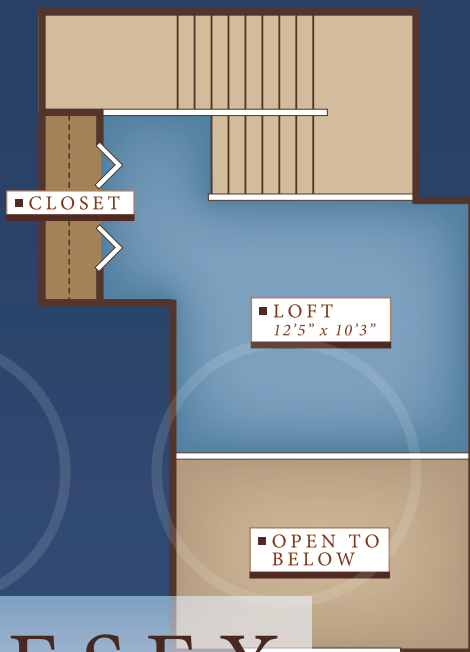

The **MIDDLESEX**

The HAMPSHIRE

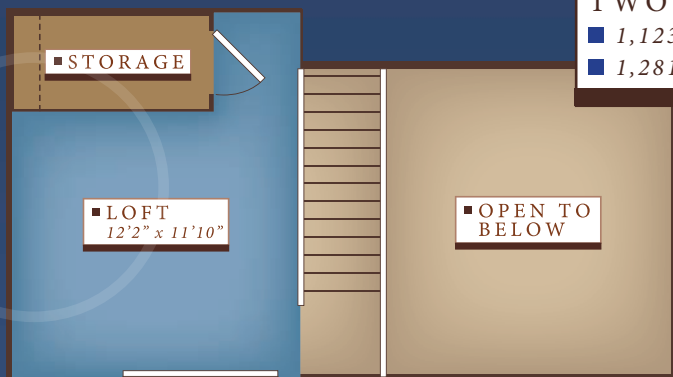
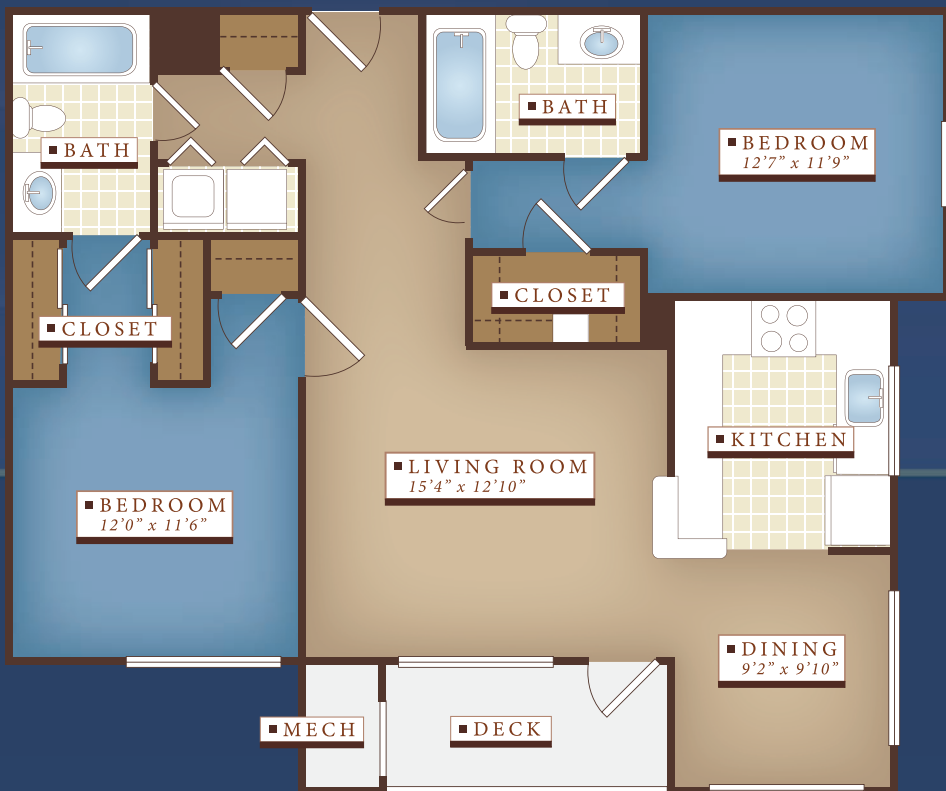

TWO BEDROOM

- 1,123 square feet
- 1,281 square feet with loft

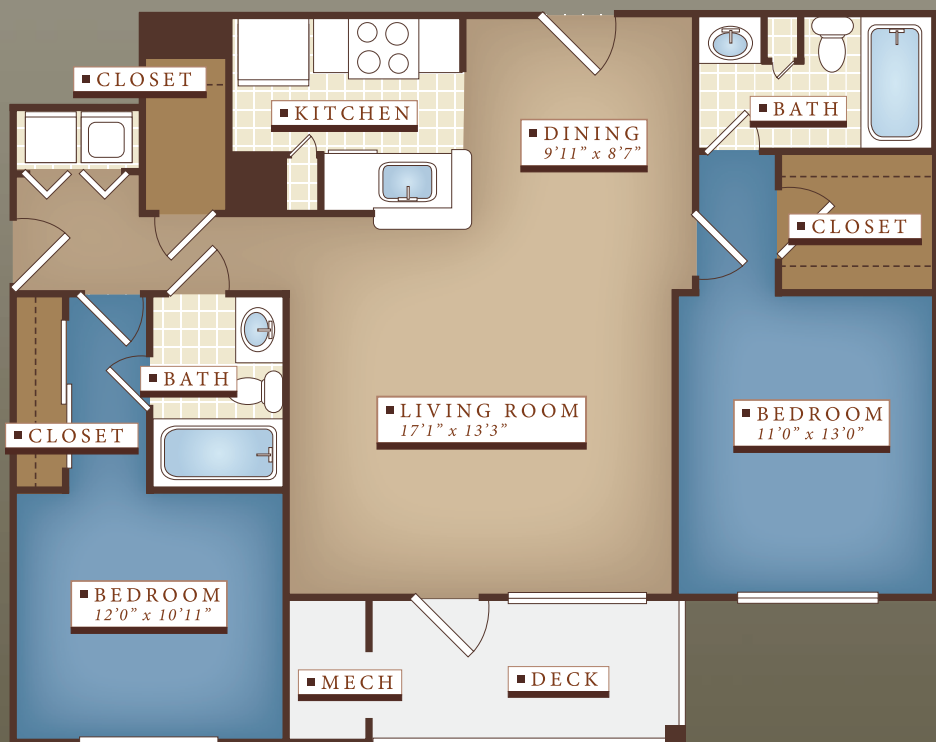

TWO BEDROOMS

■ 1,131 square feet

■ 1,308 square feet with loft

The **HAMPDEN**

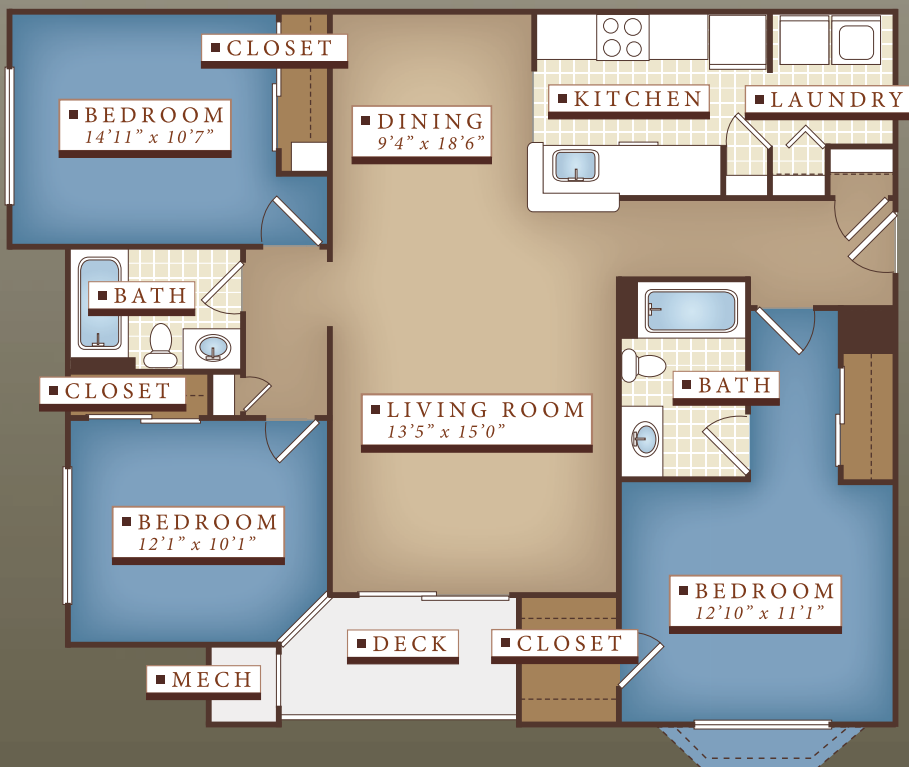

THREE BEDROOMS

■ 1,256 square feet

■ 1,463 square feet with loft

The BRISTOL

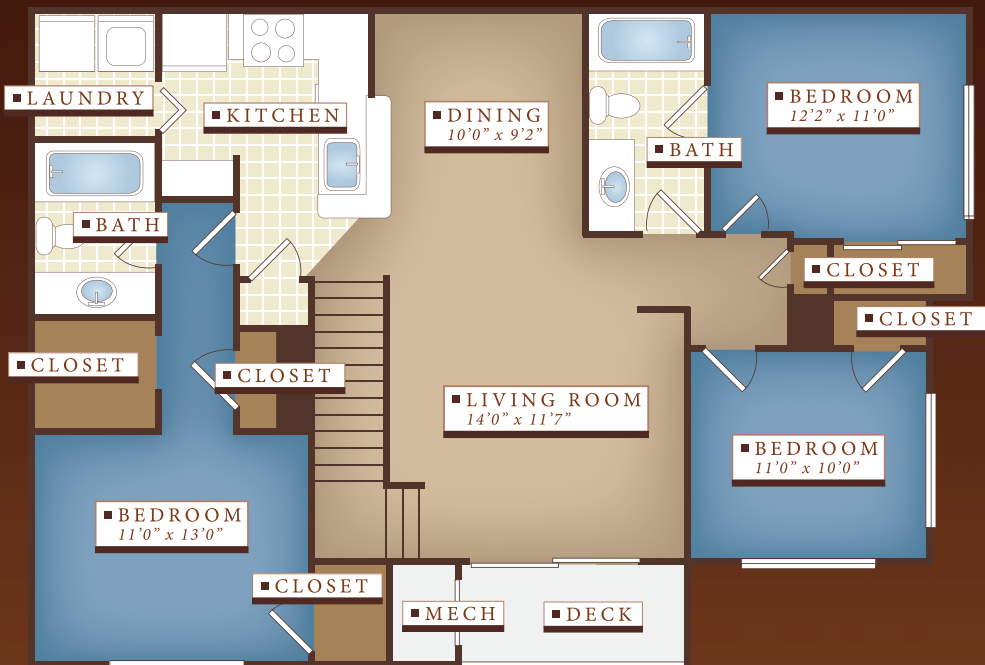

THREE BEDROOMS

■ 1,391 square feet

■ 1,573 square feet with loft

■ CLOSET

■ LOFT
11'6" x 12'1"

■ OPEN TO
BELOW

The **NORFOLK**

A LOCATION *close to* EVERYTHING.

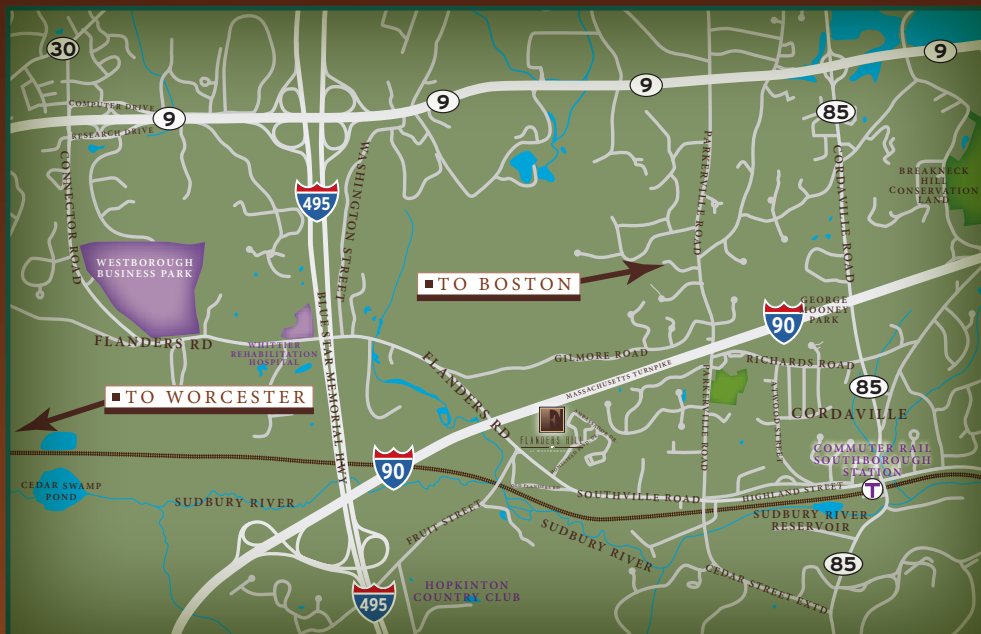

- Located close to the intersection of the Massachusetts Turnpike (Interstate Route 90) and Interstate Route 495.
- An easy 2-minute drive from Route 9 and Route 30.
- Close by to neighboring Shrewsbury, and only 10 minutes to Framingham.
- Just 30 minutes to Downtown Boston and 20 minutes to Worcester.
- MBTA Commuter Rail's Southborough Station is just 1 mile away.
- Close to several shopping centers, restaurants and points of interest.
- Nearby to beautiful State Parks in Hopkinton and Ashland.
- Nestled among rolling, wooded hills and charming suburban neighborhoods.



FLANDERS HILL

at WESTBOROUGH

508.366.8001 ■ 508.366.3930 fax

flandershill@lincolnapts.com

www.FlandersHillAtWestborough.com